

**PLEASE READ
BEFORE COMMENCING
OPERATION**

This machine is suitable
for DRY use only.

Make sure that the filtration system
fitted to the machine is suitable for the
material being collected.

Numatic

numatic.com



TRM240-11

(HARDWIRED)

Voltage variants 220-240V & 115V



M-Class

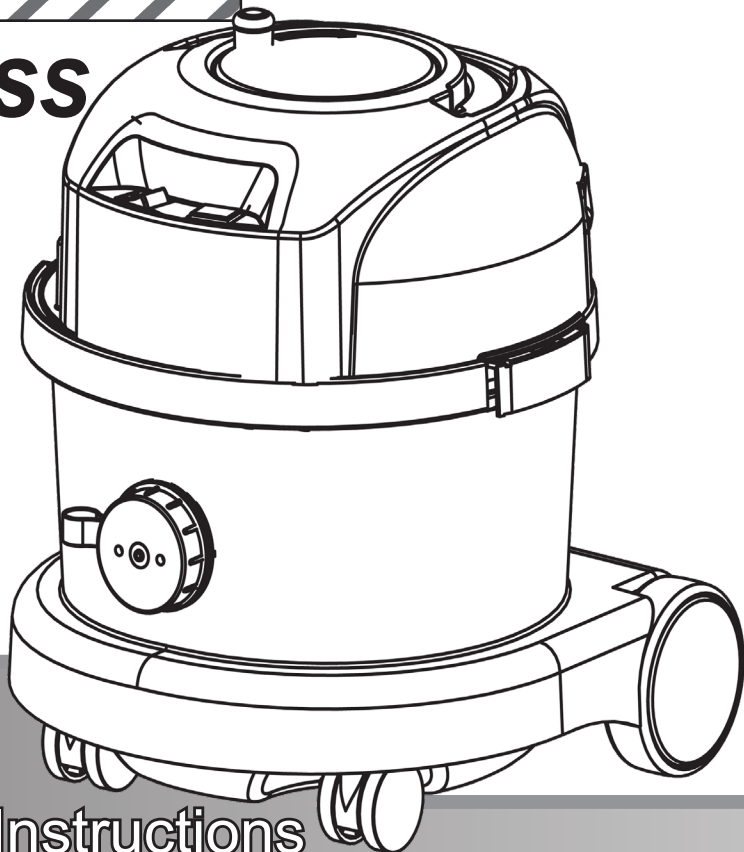

Original Instructions

CAUTION, Read the Instructions before using the machine.

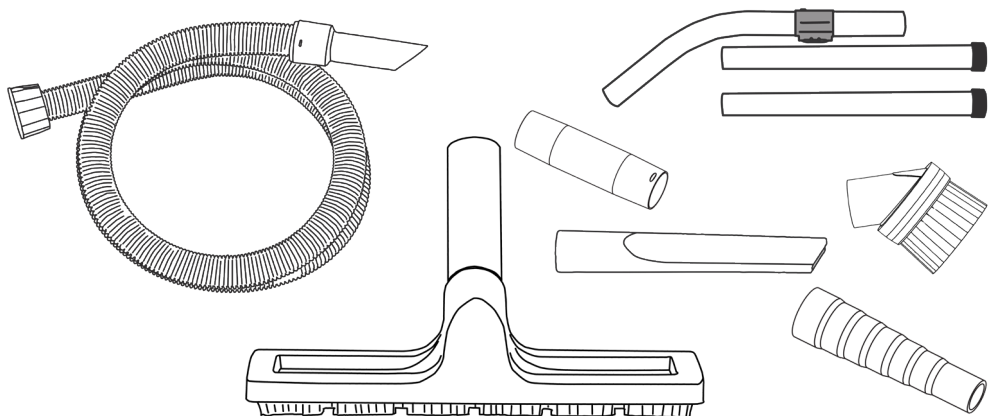

Assembly

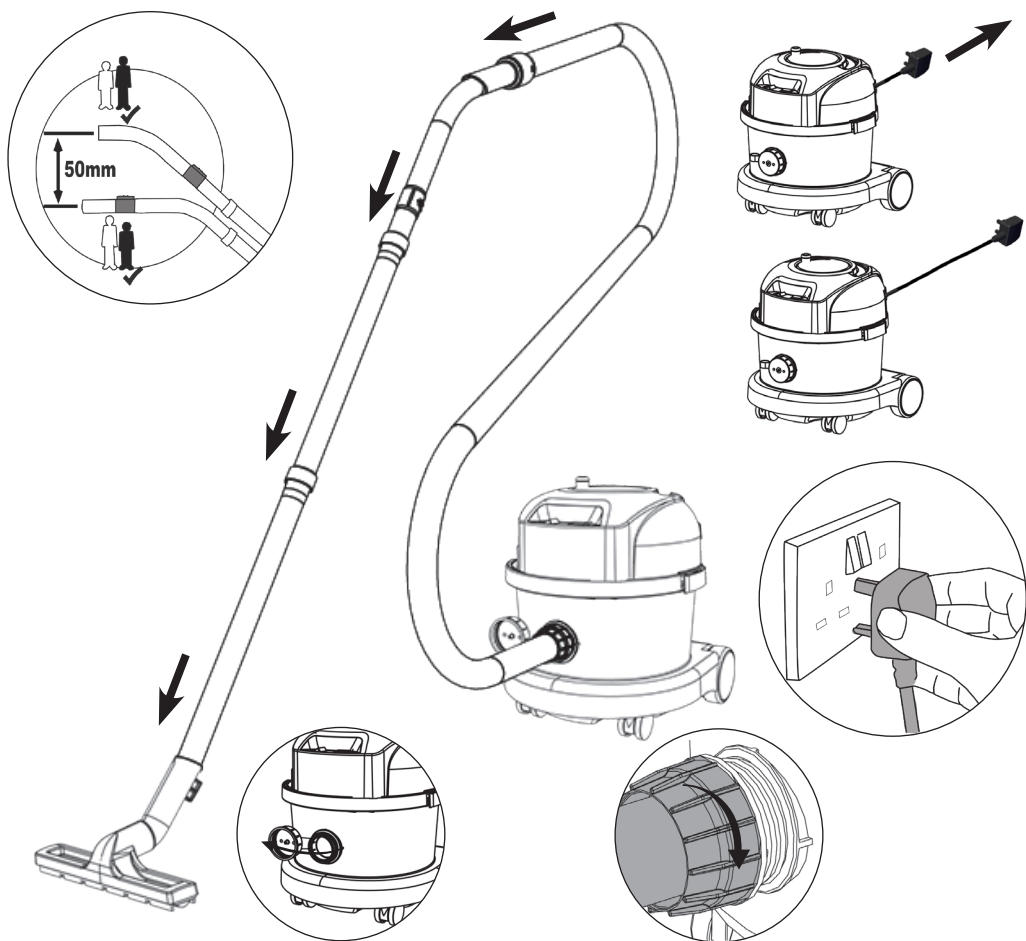

Using your machine



The vacuum cleaner is fitted with a low flow indicator. When the indicator is fully red, the air speed in the hose has dropped below 20m/s

If problem persists...	
Causes	Solution
Suction hose blocked or kinked.	Remove blockage or kink.
Filter clogged or blocked.	Replace filter cartridge.
Dust collection bag full	Replace Dust Collection bag

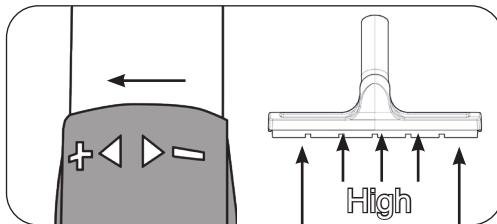
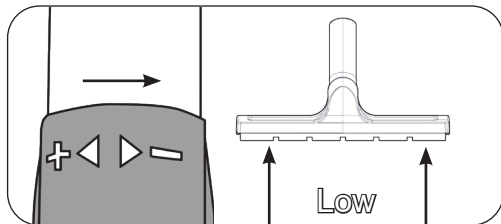
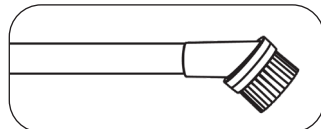
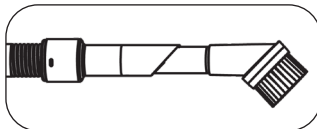
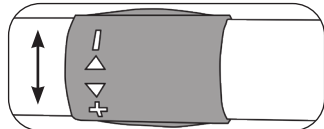
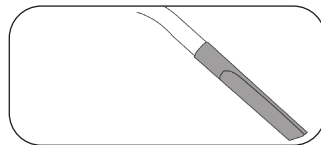
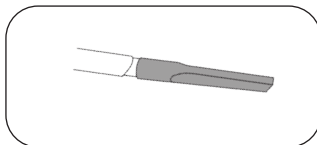
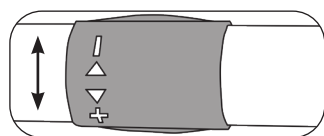

Docking

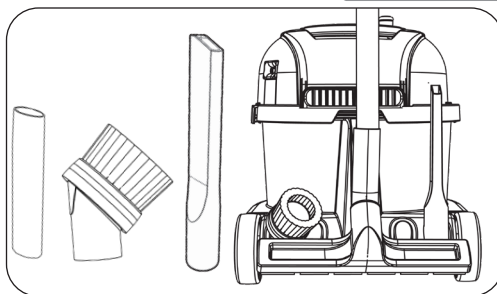
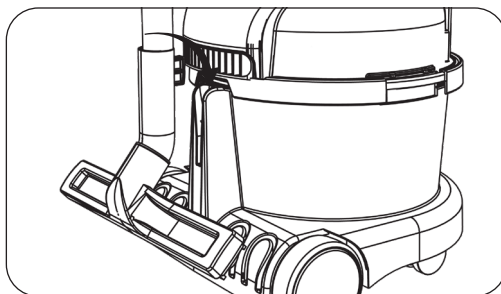

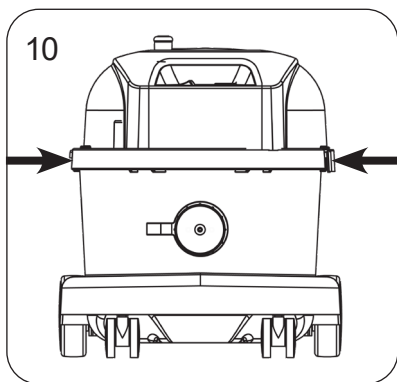
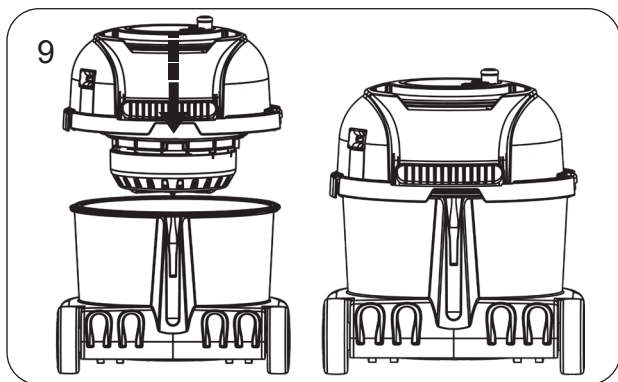
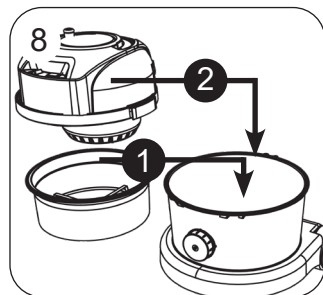
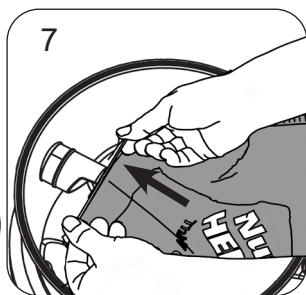
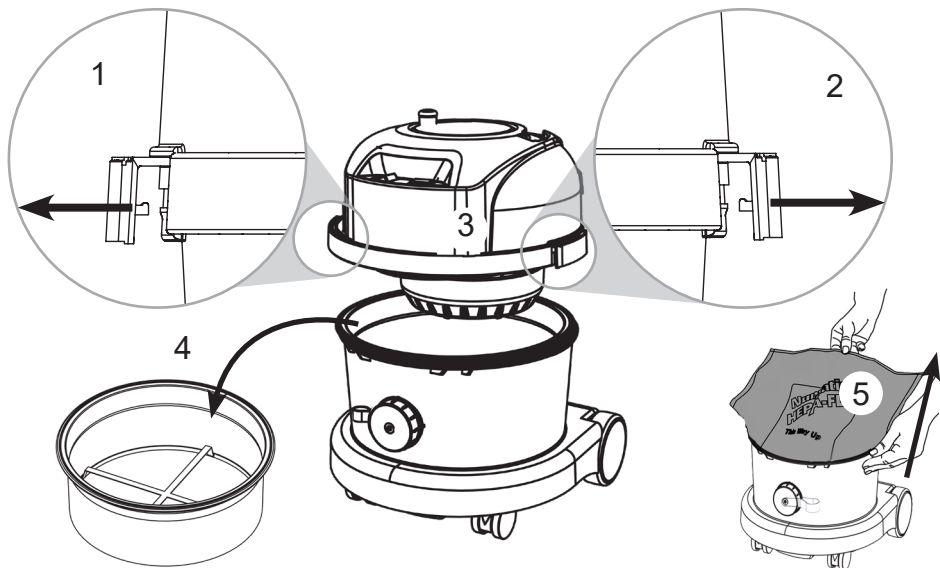

Replacing the Cartridge Filter

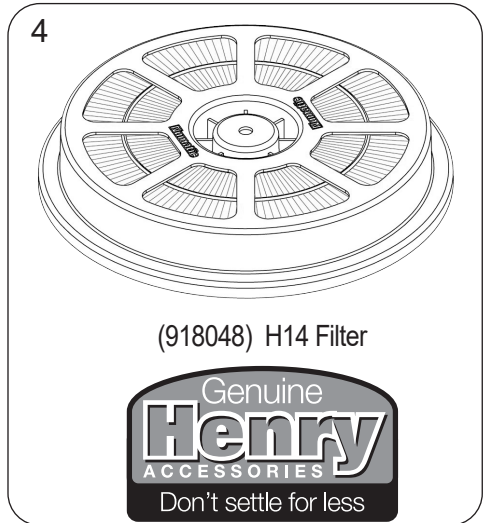
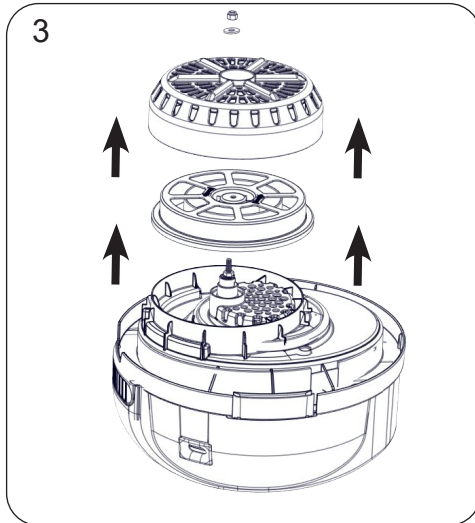
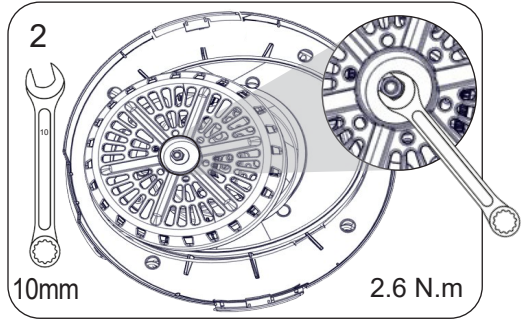
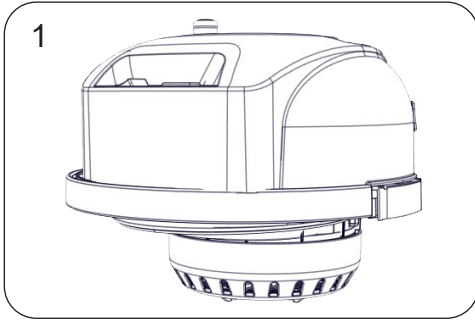

H14 Filter - Washing Procedure

1. Remove filter.
2. Place used filter into a sealed bag and move to a well ventilated area.
3. Shake the filter to remove any dust debris.
4. Wash under slow stream of cold water.
5. Shake the filter to release water and debris. Do not knock or impact filter.
6. Repeat step 3 & 4 if needed, until no water or debris visible.
7. Leave to dry in an area with plenty of airflow for 24h+.
8. Check the filter is completely dry before refitting.
9. Maximum of four washes, before a replacement is required.

H14 Filter - Use By Date

Refer to the date on the label attached to your filter.

The filter should not be used after this date and should be replaced with a genuine Numatic H14 filter (918048).

Power Rating	620W
Voltage	220-240V / 115V
Drum Size	9L
Cleaning Range	32.0m
Weight (Ready to Work)	8.1kg
Sound Pressure LpA	≤ 70 dB (A)
Sound Pressure (Uncertainty) kPA	2dB
Protection Class	Class II
Dimensions	360 mm x 360 mm x 390 mm
Max. Under Pressure (hPa)	(220-240V = 220 hPa) (115V = 228 hPa)
Max. Flow Rate	115 m³/h

Schematic Diagram

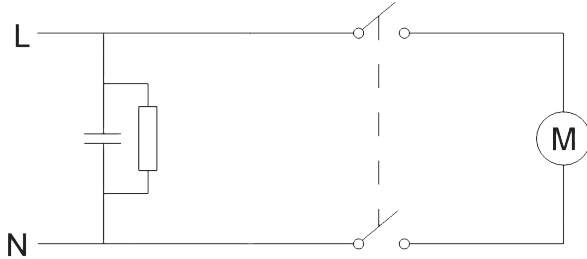

Replacement Parts



TriTex Filter	
907073	TriTex Filter
Motor Filter	
918048	H14 Pre Motor Filter
HepaFlo Dust Bags	
907076	NVH 1CH (Pack of 5)
907075	NVH 1CH (Pack of 10)

(EN) About your machine

1	Company Name & Address
2	Model
3	Voltage / Alternating Current
4	Frequency
5	Rated Input Power
6	Weight
7	WEEE Logo
8	Protection Class
9	Approval Mark
10	Machine yr/wk Serial Number

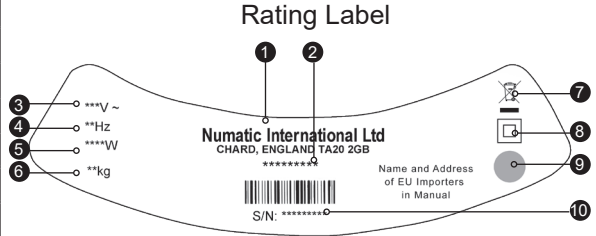

<h2 style="text-align: center;">Maintenance</h2>
<p>Daily Keep the machine clean, including hoses and tubes. Ensure the bag and filter are fitted. Regularly examine the power cord. Check dust bag frequently. Check filters are clean.</p> <p>Weekly - as daily and:- Check for any worn or damaged parts and replace immediately.</p>

WEEE (Waste, Electrical and Electronic Equipment)
 Vacuum Cleaner Accessories and packaging should be sorted for environmentally-friendly recycling.

Only for UK/EU countries.
 Do not dispose of Vacuum Cleaner into household waste.
 According to the European Directive 2012/19/EU on waste electrical electronic equipment and its incorporation into national law, vacuum cleaners that are no longer suitable for use must be separated, collected and sent for recovery in an environmentally-friendly manner.

PPE (personal protective equipment). That may be required for certain operations.

Ear Protection	Safety Footwear	Head Protection	Safety Gloves	
Eye Protection	Protective Clothing	Dust / Allergens Protection	Hi Viz Jacket	Caution Floor Sign

NOTE: A risk assessment should be conducted to determine which PPE should be worn.

Failure to rectify the problem or in the event of a breakdown contact your Numatic dealer or the Numatic Technical helpline +44 (0)1460 269268

Safety Critical Component: Mains Lead

HO5VV-F 10M x 2 Core x 1.0mm x Yellow Cable (220V-240V)

HO5VV-F 10M x 2 Core x 1.5mm x Yellow Cable (115V)

WARNING

Read the instruction manual before using the machine.

Operators shall be adequately instructed on the use of their machine.

As with all electrical equipment, care and attention must be exercised at all times during use.

Complete routine and preventative maintenance periodically to ensure safe operation.

Failure to carry out maintenance as necessary, including the replacement of parts to the correct standard could render this equipment unsafe and the manufacturer can accept no responsibility in this respect.

Maintenance should only be carried out by a qualified person.

This machine is for DRY USE only and must not be stored outside or used in wet conditions.

The machine shall be disconnected from the mains power by removing the plug from the power supply socket during cleaning or maintenance and when replacing parts or converting the machine to another function. If the supply cord is damaged, it must be replaced by the manufacturer, its service agent or similarly qualified persons in order to avoid a hazard.

Only use the socket outlet on the machine for purposes specified in the instructions (if fitted).

This appliance is not intended for use by persons (including children) with reduced physical, sensory or mental capabilities, or lack of experience and knowledge, unless they have been given supervision or instruction concerning use of the appliance by a person responsible for their safety.

This appliance is intended to be cleaned and maintained by an adult.

Children being supervised are not to play with the machine.

This machine is not a toy.

This machine is not suitable for picking up hazardous or explosive dust. Contact your local distributor if you require a machine capable of performing these tasks.

Do not allow the dust collection bag (NVM-1CH) to become so full as to reduce the effective pick-up of the vacuum.

(The Low Flow Indicator will indicate when air velocity drops below a < 20 m/s).

Only use the dust collection bag (NVM-1CH) once.

This machine must only be repaired by suitably trained and authorised personnel.

Only use genuine Numatic International Ltd spare parts, for repairs.

This machine must not be installed as a fixed extraction system or run unattended.

Operators should observe any safety regulations appropriate to materials being handled.

CAUTION

Ensure that the filtration system fitted to the machine is suitable for the material being collected.

This vacuum cleaner is intended for indoor use in the collection of dry materials.

This machine should be stored indoors only.

NOTES

This machine is intended for commercial use, for example in hotels, schools, hospitals, factories, shops, offices and rental businesses.

This product complies with the requirements of clause 20 of IEC/EN 60335-2-69 Stability and Mechanical Hazards.

This vacuum cleaner is fitted with a thermal protection device. If the vacuum cleaner stops working, remove the plug from the wall before investigating where the fault lies.

If the vacuum cleaner has a blockage, switch off, remove the plug from the socket, inspect the floor tool, tubes and hose for debris. If the floor tool, tubes and hose are clear, replace the dust bag and clean the filter.

If the supply cord is damaged, it must be replaced by the manufacturer, its service agent or similarly qualified persons in order to avoid a hazard.

The vacuum cleaner should be inspected after use for damage.

The vacuum cleaner should be stored in a dry place.

When moving from one place to another, consider the weight of the machine and ensure cap is on to reduce contamination.

Make sure you use the appropriate floor tool for the surfaces to be cleaned (Carpet / Hard Floor).

DO

- Keep your machine clean including hoses and tubes.
- Change dust bag frequently.
- Keep filters clean.
- Keep diffuser filter (where fitted) clean.
- Use filter bags, they will enhance performance and help keep machine clean.
- Use a Numatic Original filter bag under fine dust conditions.
- Keep hoses and tubes clear.
- Replace any worn or damaged parts immediately.
- Regularly examine the power cord. If damage is found such as cracking or ageing the power cord must be replaced by a qualified person.
- Only replace the power cord with the correct Numatic approved replacement part.

DO NOT

- Pull on the cable to unplug the machine from the power supply.
- Use to suck up hot ashes or lighted cigarette ends.
- Use steam cleaners or pressure washers to clean the machine or use in the rain.
- Immerse in water for cleaning.
- Attempt machine maintenance or cleaning unless the power supply plug has been removed from the supply outlet.
- Use in wet environments or to collect wet materials.
- Use hard floor tools on carpet
- Under any circumstances place foreign objects including (but not limited to) air fresheners, air freshener capsules or scented beads of any type into the top filter of the machine. Doing so can be dangerous and risk damage to the machine and may invalidate the machine warranty.
- Modify the machine or its accessories
- Operate without the full filtration system fitted.

PRODUCT INFORMATION

The vacuum cleaner is fitted with a low flow indicator. When the indicator is fully red, the air speed in the hose has dropped below 20m/s. See page 3 for trouble shooting.

PREPARATION FOR USE

Unpack and identify each item of equipment from the delivery note.

Check that the details given match the information on the "rating plate" mounted on the head assembly.

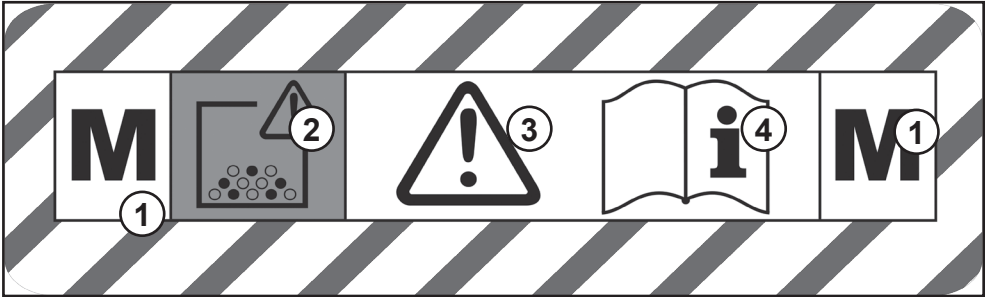

Label Explained

1 M type Vacuum Cleaner

2 Caution, debris contained inside the vacuum cleaner could be hazardous to health

3 Caution

4 Read instructions before use

Installation / Removal / Disposal of the dust bag / cartridge filter.

For M class machines, outside of the machine should be decontaminated by vacuum cleaning methods and wiped clean or treated with sealant before being taken out of a hazardous area.

The dust bag / cartridge filter holding the dust and debris must be removed and renewed by trained personnel only, wearing appropriate personnel protective equipment, in a specified de-contamination area.

Remove the cloth filter in the drum. Remove the dust bag from the hose flange inside the drum and seal the dust bag

The manufacturer, or an instructed person, shall perform a technical inspection at least annually, consisting of, for

example, inspection of filters for damage, air tightness of the machine and proper function of the control mechanism.

Place the dust bag and / or cartridge filter inside an impervious plastic bag and seal the bag.

Dispose of the plastic bag, depending on contamination, in accordance with current safety regulations.

Numatic International Warranty

Numatic International Limited warrant to the original purchaser that its products are free of defects in both material or workmanship for the period shown below:-

Homecare and Cleancare Vacuum cleaners.....	2 Years
Rotary Floor Machines.....	2 Years
Twintec Auto Scrubber Dryer.....	1 Year
Vario Ride-On Scrubber Dryer.....	1 Year / 1500 hours
Mopping, Compacts, Combi and Servocare Products.....	1 Year
Individual Accessories and Spare Parts.....	6 Months

Note: This warranty expressly excludes consumable parts such as carbon brushes, floor brushes, mops, batteries etc, that are considered replaceable from time to time during the normal working life of the machine.

Using non Numatic dustbags can be detrimental to both machine performance and life and may invalidate the Warranty.

- A. The warranty period commences from the date the goods are purchased.*
- B. All warranty claims must be processed through the Dealer from whom the equipment was purchased. The Dealer will co-operate with the purchaser throughout the warranty claims procedure and will arrange any necessary repairs using genuine Numatic parts.*
- C. If the original Dealer is no longer able to fulfil his obligations please contact Numatic International Limited with full details of the claim and proof of purchase so that this may be processed without delay.*
- D. Any warranty claim can only relate to the specific part that is proven to be at fault and for which a replacement will be supplied but cannot be extended to constitute a claim against the complete machine.*
- E. Numatic International will supply the Dealer with any warranty parts required, subject to the claim being validated, after return of the faulty items in accordance with Numatic International Limited's General Conditions of Sale.*
- F. Claims will not be accepted if they are the result of fair wear and tear, misuse or abuse of any kind.*
- G. No replacement will be given unless the appropriate evidence of the validity of the claim has been provided to the satisfaction of Numatic International Limited.*
- H. Numatic International Limited reserve the right to charge for any unnecessary work carried out as a result of an invalid claim.*
- I. No variation to this warranty may be made or implied by any member of Numatic International Limited or its Dealers unless such variation is in writing and authorised by the Company*

Numatic

Numatic International Limited. Chard, Somerset, TA20 2GB

Telephone: 01460 68600 Fax: 01460 68458

© Numatic International Limited

UKCA Declaration of Conformity	
Manufacturer:	Numatic International Limited Chard Somerset TA20 2GB www.numatic.co.uk
Product:	TRM
Description:	Vacuum Cleaner – Commercial – Hazardous
We, Numatic hereby declare under our sole responsibility, that the above-mentioned product(s) is/are in conformity with the following directives and standards.	
S.I. 2008: 1597	Supply of Machinery Regulations EN60335-1:2012 + AC:2014 + A11:2014 + A13:2017 + A15:2021
S.I. 2016: 1091	EMC Regulations EN60335-2-69:2012 EN62233:2008 EN55014-1:2017 + A11:2020 EN55014-2:1997 + A1:2001 + A2:2008 EN61000-3-2:2014 EN61000-3-3:2013
S.I. 2012: 3052	RoHS Regulations

Authorised Signatory: Mr. Matthew Coles

Position: Head of Technology

Signed: *M Coles* Date: 17th Sep 2024

Numatic International Limited,
Chard,
Somerset, TA20 2GB, UK

EU, EC, UE, ES: Konformitaetserklaerung Prohlášení o shodě Konformitätsklärung Overensstemmelseserklæring Declaración de conformidad Déclaration de conformité	Декларация за съответствие Kajmunka deklaracija Megfelelőségi nyilatkozat Dichiarazione di conformità Atiștitățile declarația Conformiteitsverklaring Declaração de conformidade	Deklaracija zgodnosti Kajmunka deklaracija Prohlášení o shodě Konformitätsklärung Overensstemmelseserklæring Declaración de conformidad Déclaration de conformité
Manufacturer: / Виработчик / Hersteller / Fabricant / Fabricante / Toonla / Fabricant / производелач / Κατασκευαστής / Gyártó / Fabricante / Gaminėje / Fabrikant / Produzent / Fabricante / Producteur / Producent / произвођачиње / Tilværettere / Prøuzvojalca / Valmistaja	Numatic International Limited Chard Somerset TA20 2GB www.numatic.co.uk	
Product: / Произд / Produkt / Produk / Produkto / Tooleid / Produkt / Prodykt / Prodykt / Products / Tooyas / Produkto / izdelka / Tuetes / Kirjalduis / La description / Omschrijving / Beschrijving / Description / Opis / Discripcie / Omschrijving / Beskrivning / Omskrivelse / Beskrivelse / Beschreibung / Beschreibung / Omschrijving / Kuvauks:	TRM	
Description: / Kirjalduis / La description / Omschrijving / Beschrijving / Description / Opis / Discripcie / Omschrijving / Beskrivning / Omskrivelse / Beschrievung / Beschreibung / Beschreibung / Omschrijving / Kuvauks:	Vacuum Cleaner – Commercial – Hazardous	

BG Mes, Numatic klevy bezbedna under our sole responsibility, that the above-mentioned product(s) is/are in conformity with the following directives and standards.	PT Mes, Numatic declara, sob a nossa exclusiva responsabilidade, que o produto acima mencionado está em conformidade com as diretivas e normas a seguir.
CZ My, Numatic prohlašuje, na svou vlničnou odpovědnost, že výše uvedený výrobek je v souladu s následujícími směrnici a normami.	PL My, Numatic niniejszym oświadczamy, że powyższe urządzenie jest zgodne z następującymi dyrektywami i normami.
DE Wir, Numatic erklären in alleiniger Verantwortung, dass das oben genannte Produkt den folgenden Richtlinien und Normen entspricht.	RO Noi, Numatic Pro, prezenta declarăm în propria răspundere, că produsul mai sus menționat este în conformitate cu următoarele standarde și directive.
DK Vi, Numatic erklærer hermed under eget ansvar at ovennævnte produkt(er) er i overensstemmelse med følgende direktiver og standarder.	RU Мы, Нуматик омаи заявляем, что данный продукт соответствует, по своему усмотрению, следующим директивам и стандартам.
ES Nosotras, Numatic declaramos bajo nuestra única responsabilidad que el producto antes mencionado está en conformidad con las siguientes directivas y normas.	SE Vi, Numatic förklarar härmed under eget ansvar att ovan nämnda produkt överensstämmer med följande direktiv och normer.
EE Meie, Numatic klassifitseerime kännatama ja muusikultuurilise vastutuse, et seadpool nimetatud tootele on kooskõlas järgmistega direktivide ja normidega.	SI Mi, Numatic izjavljamo s peho odgovornostjo, da našo napravo izdelek v skladu z naslednjimi smernicami in standardi.
FR Numatic déclare sous notre seule responsabilité que le produit mentionné ci-dessus est conforme aux directives et normes suivantes.	UK We, Numatic hereby declare under our sole responsibility, that the above-mentioned product(s) is/are in conformity with the following directives and standards.

2006/42/EC	Machinery Directive EN60335-1:2012 + AC:2014 + A11:2014 + A13:2017 + A15:2021 EN60335-2-69:2012 EN62233:2008
2014/30/EU	EMC Directive EN55014-1:2017 + A11:2020 EN55014-2:1997 + A1:2001 + A2:2008 EN61000-3-2:2014 EN61000-3-3:2013
2011/65/EU	RoHS Directive

Authorised Signatory: Mr. Matthew Coles

Position: Head of Technology
Numatic International Limited
Chard,
Somerset, TA20 2GB, UK

Signed: *M Coles* Date: 17th September 2024



numatic.com

Numatic International Limited (Head Office)

Chard, Somerset TA20 2GB, UNITED KINGDOM
Tel: 01460 68600 numatic.com

Numatic International GmbH

Fränkische Straße 15-19, 30455 Hannover, DEUTSCHLAND
Tel: +49 (0) 511 984 2160 numatic.de

Numatic International Denmark

Fränkische Straße 15-19, 30455 Hannover, DEUTSCHLAND
Tel: +45 (0) 316 40808 numatic-online.dk

Numatic International S.A.S

13/17 rue du Valengelier, EAE la Tuilerie, 77500 Chelles, FRANCE
Tel: +33 (0) 164 726 161 numatic.fr

Numatic International BV

Vennootsweg 15, 2404 CG, Alphen aan den Rijn, NEDERLAND
Tel: +31 (0) 172 467 999 numatic.nl

Numatic International Schweiz AG.

Sihlbrugstrasse 3A, 6340 Baar, SCHWEIZ
Tel: +41 (0) 41 768 0760 numatic.ch

Numatic International (PTY) Ltd.

Cnr. 16th & Pharmaceutical Road, Randjes Park, Midrand 1685, SOUTH AFRICA
Tel: +27 (0) 861 686 284 numatic.co.za

Numatic International ULDA

Rua Francisco da Silva Duarte, nº79,
4475-269 Santa Maria de Avioso, Castêlo da Maia, PORTUGAL
Tel: +351 220 047 700 numatic.pt

NUMATIC INTERNATIONAL SPAIN, S.L.U.

Av. Baix Llobregat, 5-7, Oficina bajos 1 (Parc Negocis Mas Blau II),
08820 El Prat de Llobregat (Barcelona) SPAIN
Tel: +34 93 647 22 22 numatic.es

Numatic International Italy S.R.L

Via Luigi Galvani, 2, Z.I. Talponedo, 33080 Porcia (PN), ITALY
Tel: +39 (0) 434 046 211 numatic.it

Specification subject to change without prior notice
numatic.com © Numatic International Limited